

THE BALLROOM

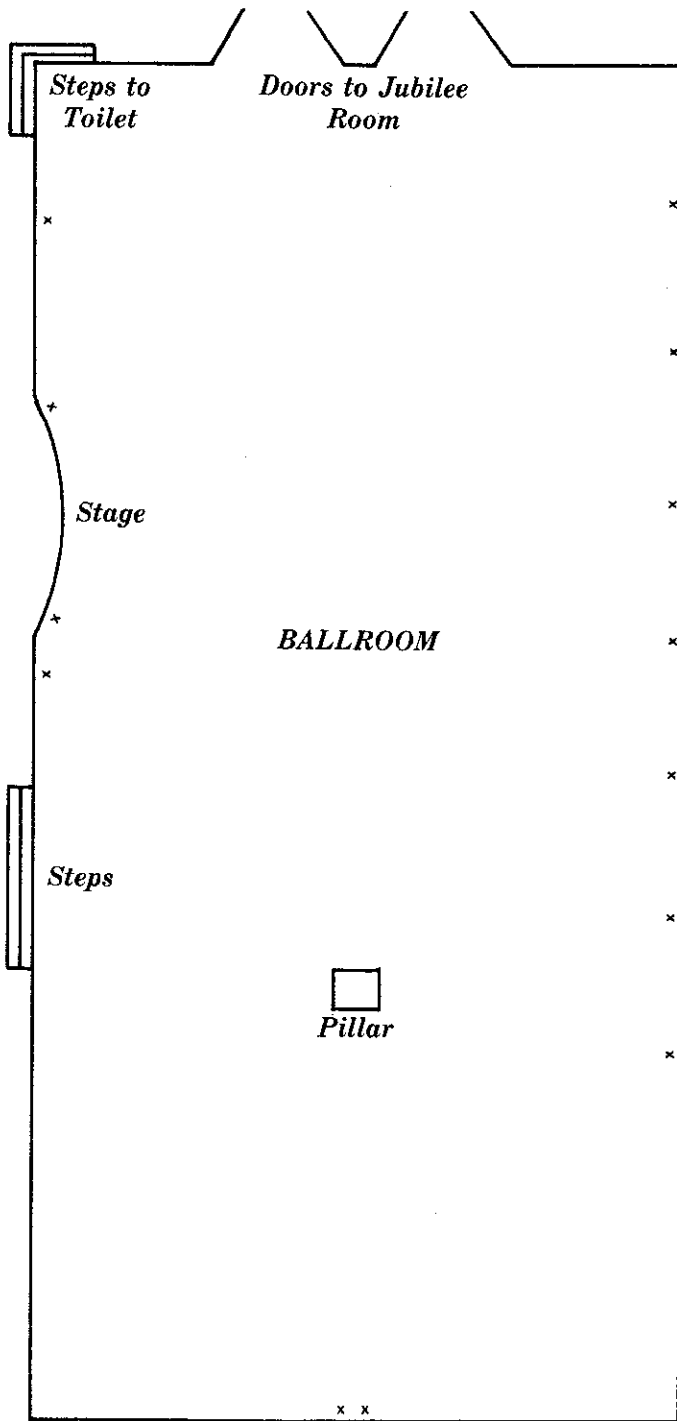

<i>Utilities</i>	<i>Television Point</i> <i>Telephone Socket</i> <i>13 Amp Sockets (x on plan)</i>	<i>Ballroom</i> ✓ ✓ 13
<i>Capacities</i>	<i>Theatre</i> <i>Classroom</i> <i>Top Table and Sprigs</i> <i>Hexagon</i> <i>Dinner Dance</i> <i>Buffet</i> <i>Exhibition</i>	200 100 180 18 130 180 ✓
<i>Dimensions</i>	<i>Length</i> <i>Width</i> <i>Ceiling Height (minimum)</i> <i>Area</i>	60ft 29ft 8ft-10ft 1740sq ft